

THIS MANUAL IS FOR THE FOLLOWING MODELS

Dieses Handbuch gilt für die folgenden Modelle | Ce manuel concerne les modèles suivants | Este manual es para los siguientes modelos | 此手册适用于以下型号

PH-GO360M25G2_DBK02 Glacier One M25-360 G2 Black
PH-GO360M25G2_DWT02 Glacier One M25-360 G2 White

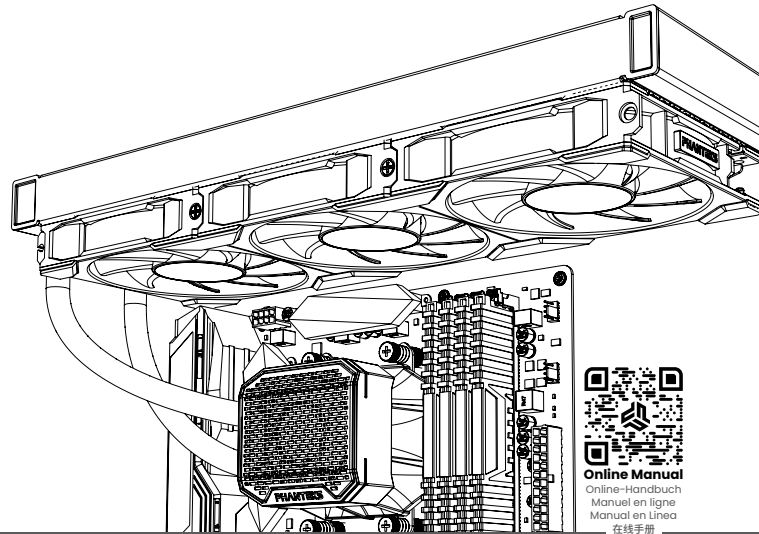

LEGEND

Legende | Légende | Leyenda | 说明

- Remove | Entfernen | Retirer | Eliminar | 移除
- Install | Installieren | Installer | Instalar | 安装
- Loosen | Lösen | Desserrer | Aflojar | 拧松

- EN** Phanteks will not take responsibility for any damages incurred due to incorrect installation or usage of this product.
- DE** Phanteks übernimmt keine Verantwortung für Schäden, die durch eine falsche Installation oder Verwendung dieses Produkts entstehen.
- FR** Phanteks décline toute responsabilité en cas de dommages résultant d'une installation ou d'une utilisation incorrecte de ce produit.
- ES** Phanteks no se responsabilizará de los daños ocasionados por la instalación o el uso incorrectos de este producto.
- CN** Phanteks 不会对安装中失误造成的任何损失负责, 请仔细阅读本手册。

SCOPE OF DELIVERY

Lieferumfang | Contenu de la livraison | Alcance de la entrega | 供货范围

GLACIER ONE M25 GEN2

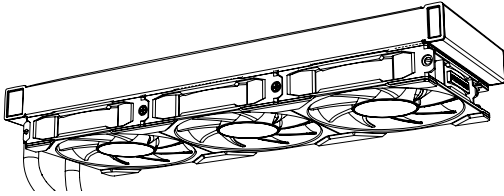

Radiator
M25 Gen2 Fans

MOUNTING HARDWARE

Montagezubehör | Le matériel de montage | Accesorios de montaje | 安装硬件

- AM4 | AM5 Stand-off**
x4
- Intel 2011 | 2066 Stand-off**
x4
- Intel 115X | 1200 Stand-off**
x4
- TR4 Stand-off**
360 Models only
x4
- Intel 1700 Stand-off**
x4
- Thumb Nuts**
x4
- AMD AM4 | AM5 Bracket**
Intel bracket is pre-installed
x1
- AMD TR4 Bracket**
360 Models only
x1
- Radiator Screws**
6 mm | 6-32 UNC
x12¹
- Radiator Screws**
30 mm | 6-32 UNC
x12¹
- Tube Clips**
x3
- SATA to 2-PIN Pump Adapter**
x1
- PH-NDC Thermal Compound**
x1

ACCESSORIES

Zubehör | Accessoires | Accesorios | 配件

- LINQ6 Extension Cable**
500 mm
x1
- LINQ6 Adapter**
500 mm
x1
- Screw Cover Corners**
Left | Right
x2¹ | x2¹
- Screw Cover Bridge**
x4¹

IMPORTANCE NOTICE

Quantity may vary on radiator size.
 Die Menge kann je nach Heizkörpergröße variieren.
 La quantité peut varier selon la taille du radiateur.
 La cantidad puede variar según el tamaño del radiador.
 数量可能根据散热器尺寸而变化。

1. PREPARE MAINBOARD

Mainboard vorbereiten | Préparer la carte mère | Preparar la placa base | 准备主板

INTEL 115X | 1200 | 1700

PROCEED TO STEP 2. >

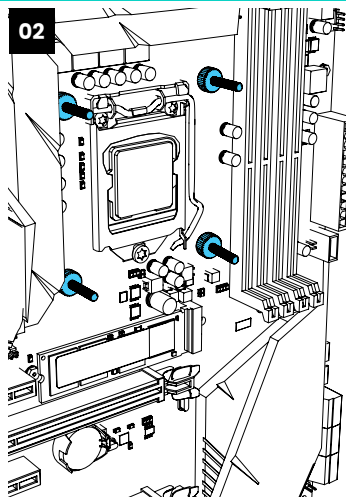
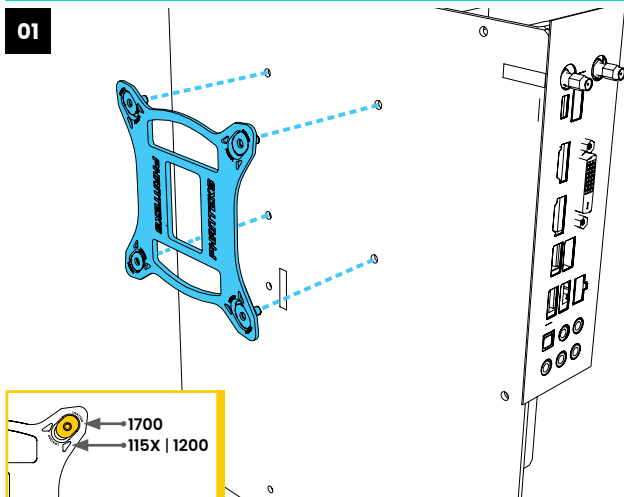

INSTALL	INSTALL
115X 1200 STAND-OFF 4x	1700 STAND-OFF 4x



ATTENTION
Check the stand-off texture to make sure you got the correct socket stand-off.

DE Überprüfen Sie die Abstandhalterstruktur, um sicherzustellen, dass Sie den richtigen Sockelabstandhalter haben.

FR Vérifiez la texture de l'écartement pour vous assurer que vous avez obtenu l'écartement correct de la douille.

ES Verifique la textura del separador para asegurarse de obtener el separador de enchufe correcto.

CN 检查支架纹理, 确保您获得正确的插座支架。

INTEL 2011 | 2066

PROCEED TO STEP 2. >

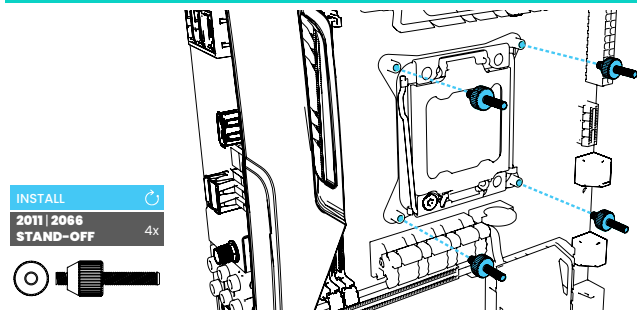

AMD AM4 | AM5

PROCEED TO STEP 2. >

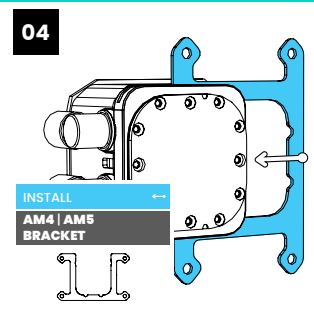
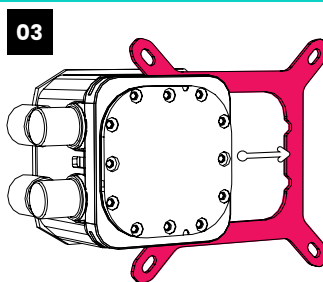
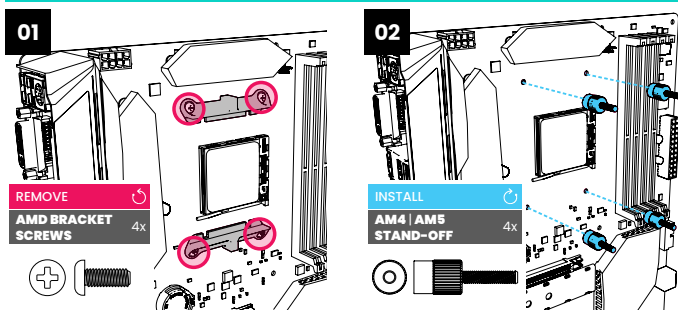

AMD TR4

PROCEED TO STEP 2. >

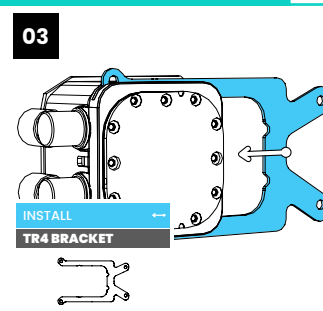
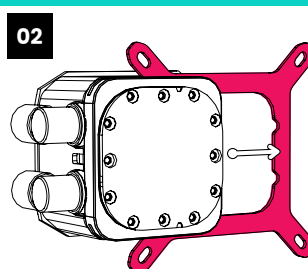
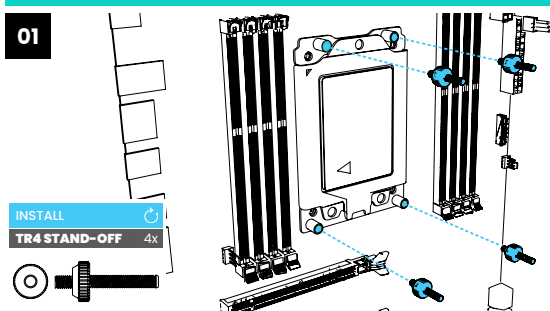



2. INSTALLING CPU BLOCK

CPU-Block installieren | Installation du bloc CPU | Instalación del bloque de CPU | 安装CPU块

SECURE CPU BLOCK

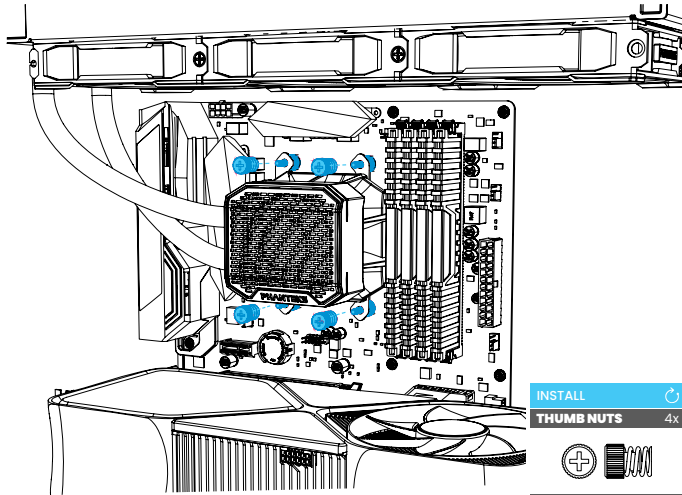
Linke Seitenwand | Panneau latéral gauche | Panel lateral izquierdo | 左侧面板



INSTALL 
THUMB NUTS 4x

FUTURE INSTALLATION: APPLY THERMAL PASTE

Linke Seitenwand | Panneau latéral gauche | Panel lateral izquierdo | 左侧面板

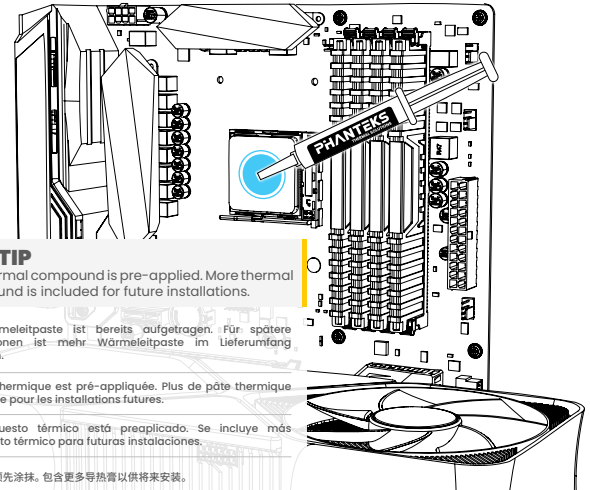

PRO TIP

The thermal compound is pre-applied. More thermal compound is included for future installations.

- DE** Die Wärmeleitpaste ist bereits aufgetragen. Für spätere Installationen ist mehr Wärmeleitpaste im Lieferumfang enthalten.
- FR** La pâte thermique est pré-appliquée. Plus de pâte thermique est incluse pour les installations futures.
- ES** El compuesto térmico está preaplicado. Se incluye más compuesto térmico para futuras instalaciones.
- CN** 导热膏已预先涂漆。包含更多导热膏以供将来安装。

3. MOUNT THE RADIATOR AND FANS

Montieren Sie den Kühler und die Lüfter | Montez le radiateur et les ventilateurs | Monte el radiador y los ventiladores | 安装散热器和风扇

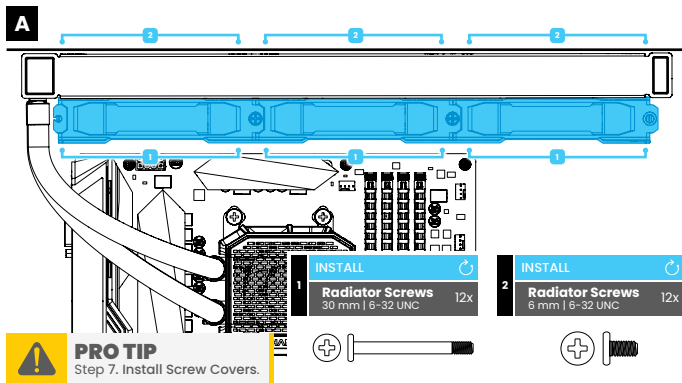

INSTALL 
Radiator Screws
 30 mm | 6-32 UNC 12x

INSTALL 
Radiator Screws
 6 mm | 6-32 UNC 12x

PRO TIP
 Step 7. Install Screw Covers.

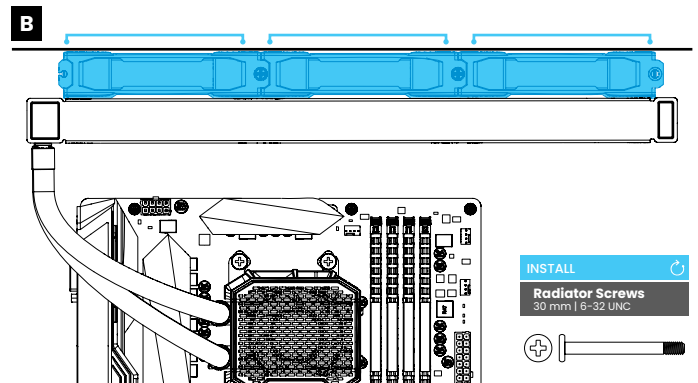

INSTALL 
Radiator Screws
 30 mm | 6-32 UNC

4. INSTALL TUBE CLIPS

Rohrschellen montieren | Installer les clips pour tubes | Instalar clips de tubo | 安装管夹

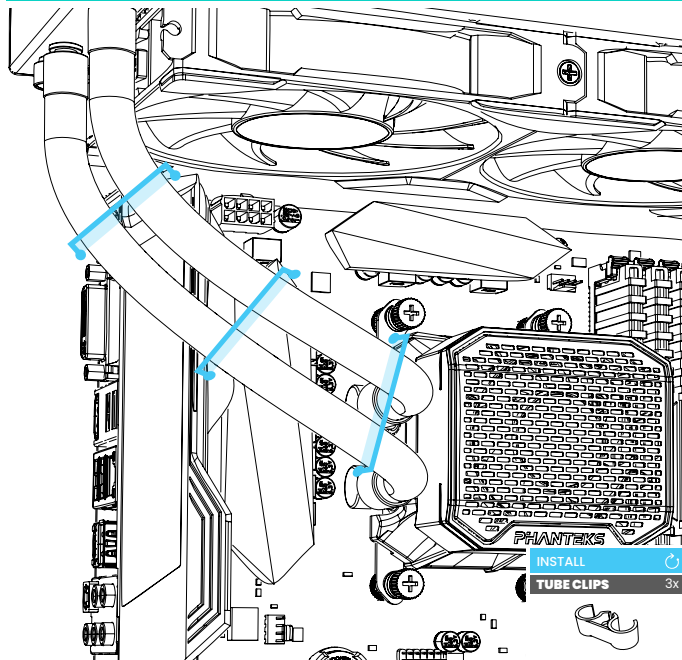

INSTALL 
TUBE CLIPS 3x

5. CONNECT PUMP MODULE

Pumpenmodul anschließen | Connecter le module de pompe | Conecte el módulo de bomba | 连接泵模块

PUMP CABLES

Pumpenkabel | Câbles de pompe | Cables de bomba | 泵电缆

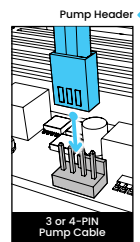
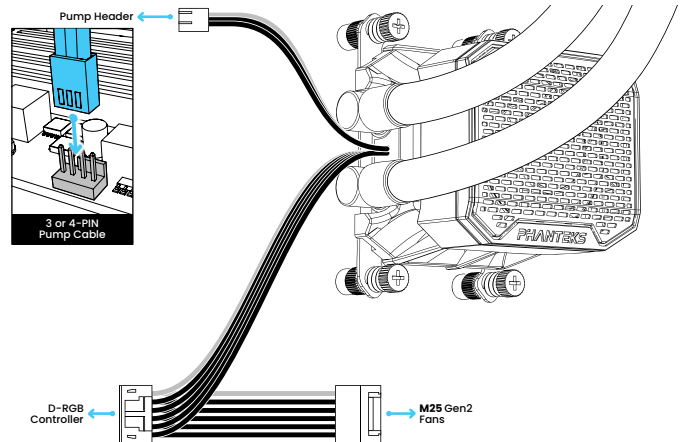

3 or 4-PIN Pump Cable

D-RGB Controller  M25 Gen2 Fans

6. CONNECT FAN CABLE

Lüfterkabel anschließen | Connectez le câble du ventilateur | Conectar el cable del ventilador | 连接风扇电缆

LINQ6 FAN CABLE

LINQ6 Lüfterkabel | Câble de ventilateur LINQ6 | Cable de ventilador LINQ6 | LINQ6 风扇电缆

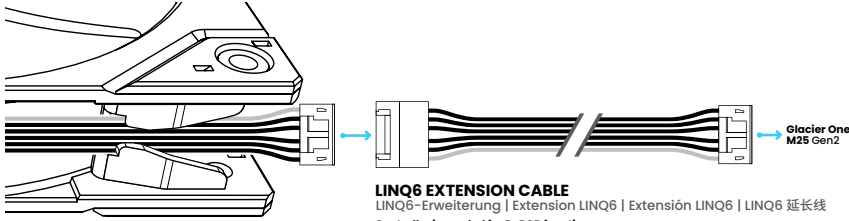

LINQ6 EXTENSION CABLE

LINQ6-Erweiterung | Extension LINQ6 | Extensión LINQ6 | LINQ6 延长线

Controller is needed for D-RGB functions.

Für D-RGB-Funktionen ist ein Controller erforderlich.

Un contrôleur est nécessaire pour les fonctions D-RGB.

Se necesita un controlador para las funciones D-RGB.

D-RGB 需要控制器以使用 D-RGB 功能。

OPTIONAL: LINQ6 ADAPTER

Optional: LINQ6-Adapter | En option: adaptateur LINQ6 | Opcional: Adaptador LINQ6 | 可选项: LINQ6 转接线



IMPORTANCE NOTICE

Follow mainboard manual for instructions on D-RGB control.
Befolgen Sie für Anweisungen zur D-RGB-Steuerung das Motherboard-Handbuch.
Suivez le manuel de la carte mère pour obtenir des instructions sur le contrôle D-RGB.
Siga el manual de la placa base para obtener instrucciones sobre el control D-RGB.
按照主板手册了解 D-RGB 控制说明。

7. INSTALL SCREW COVERS

Schraubenabdeckungen anbringen | Installer les cache-vis | Instalar cubiertas de tornillos | 安装螺丝盖

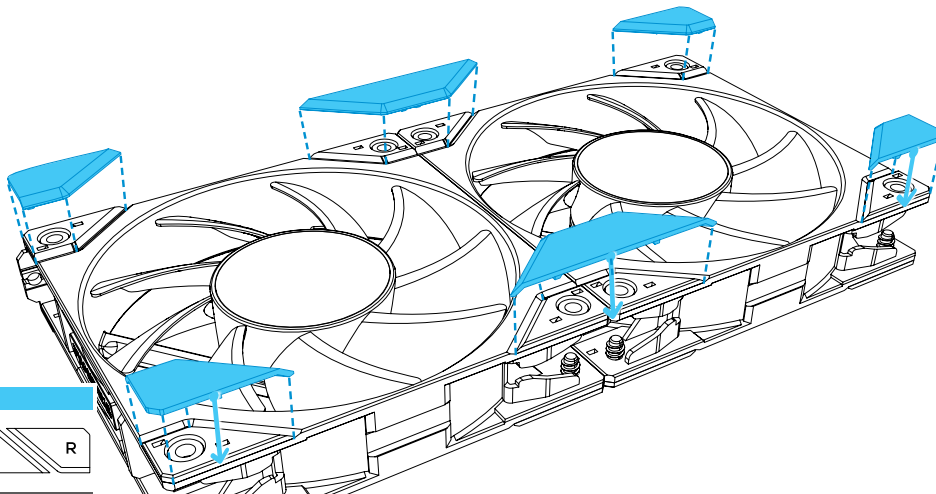

Screw Covers



SUPPORT & WARRANTY

Support und Garantie | Assistance et garantie | Soporte y garantía | 支持和保修

EN As a Phanteks customer, you are priority number one for us. We have a dedicated team across the globe to deliver the experience you deserve. If you have any issues with the products, please don't hesitate to contact our customer care team.

DE Als Phanteks-Kunde haben Sie für uns oberste Priorität. Wir haben ein engagiertes Team auf der ganzen Welt, das Ihnen das Erlebnis bietet, das Sie verdienen. Wenn Sie Probleme mit den Produkten haben, zögern Sie bitte nicht, unser Kundendienstteam zu kontaktieren.

FR En tant que client Phanteks, vous êtes la priorité numéro un pour nous. Nous disposons d'une équipe dédiée à travers le monde pour vous offrir l'expérience que vous méritez. Si vous rencontrez des problèmes avec les produits, n'hésitez pas à contacter notre équipe de service client.

ES Como cliente de Phanteks, usted es la prioridad número uno para nosotros. Contamos con un equipo dedicado en todo el mundo para brindarle la experiencia que se merece. Si tiene algún problema con los productos, no dude en ponerse en contacto con nuestro equipo de atención al cliente.

CN 作为 Phanteks 客户，您是我们的第一要务。我们在全世界拥有一支专业团队，为您提供应有的体验。如果您对产品有任何问题，请随时联系我们的客户服务团队。

RMA and Technical Support Americas

Hours: Monday-Friday 9:00-5:00 PST

Phone number: +1(909)598-2115

Email: support@phanteksusa.com

Facebook: @Phanteks

RMA and Technical Support International

Email: support@phanteks.com

Facebook: @Phanteks

For spare parts and optional upgrades please visit:
www.axpertec.com (EU) | www.phanteksusa.com (US)



SAFETY INFORMATION

SICHERHEITSMITTEILUNG | INFORMATION DE SÉCURITÉ | INFORMACIÓN DE SEGURIDAD | 安全信息

In order to achieve maximum safety, we suggest that you adopt the following guidelines:

- Place the product on a clean and stable surface that allows adequate air ventilation.
- Don't use or place the product and any of its components near water, moisture, or other wet surfaces; or place the product near any heat, open flame, or other hot surfaces such as radiators, stoves, fireplaces, and candles.
- Use caution when operating the desktop PC to avoid electrical shock or damage, such as unplugging the power supply during thunderstorms, ensuring that your hands are dry before using (and handling) the desktop PC, keeping it away from any source of liquid and/or heat source, and using all other reasonable precautions needed under the circumstances.
- When connecting external devices to your desktop PC, carefully plan how the wires will be placed. Protect any connected cables from being trod on or pinched, particularly at plugs, convenience receptacles, or the point where they exit from.
- Take extra caution when handling/removing/reattaching glass components. Once removed, place the glass component on a stable surface first before proceeding.
- When unplugging any connected devices and/or cables, always pull the cable or device's plug or connector. Don't forcefully tug on its cord.
- Don't place any heavy items on top of the product.
- Make sure that the desktop PC is off, unplugged from the outlet, and that all connected devices are powered off and unplugged (if any) before installing or uninstalling any internal component to and/or from the desktop PC or product.



FR

Cet appareil se recycle

REPRISE À LA LIVRAISON

À DÉPOSER EN MAGASIN

À DÉPOSER EN DÉCHÈTERIE

Points de collecte sur www.quefairede mesdechets.fr

Privilégiez la réparation ou le don de votre appareil!



NOTE ON DISPOSAL

The WEEE symbol indicates that this product must not be disposed of with normal household waste. Through the correct disposal of this product, you will help protect the environment. For more information on the disposal of this product, please contact your local municipality, your waste disposal service or the shop where you purchased the product.

Phanteks Taiwan Inc.
11F, No. 150, Jian 1st Rd.,
Zhonghe Dist.
New Taipei City 235

Importer EU
Axpertec Int. B.V. (EU)
Sydneystraat 33
3047 BP Rotterdam
The Netherlands

Importer US
Axpertec Inc. (US)
20465 E Walnut Dr. N
City of Industry, CA 91789
USA